

## MPLC0730L1R5

Aliases (UPID0730L1R500)

Not for New Design

EOL : Alternate PN - MPXID0630L1R5

KEMET, MPLC, Metal Composite, 20%, 1,500 nH

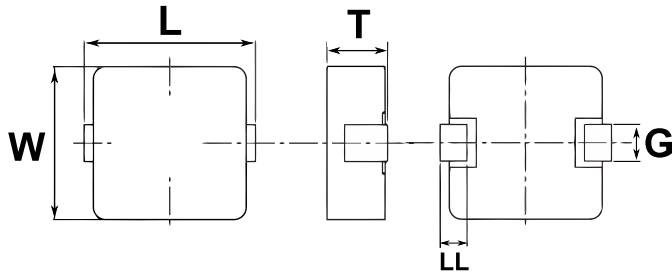

Click [here](#) for the 3D model.

### General Information

Series	MPLC
Style	SMD Molded
Core	Metal Composite
Description	Shielded, Surface Mount Inductor
Features	Large Current Inductors
RoHS	Yes

Dimensions	
L	7.7mm MAX
W	6.7mm +/-0.2mm
T	3mm MAX
G	3.2mm +/-0.1mm

Packaging Specifications	
Packaging	T&R, 330mm
Packaging Quantity	1000

Specifications	
Inductance	1.5 uH (0.1 MHz)
Inductance Tolerance	20%
Rated Current	8.6 Amps (Irms, 40C Rise By Self Heating)
Saturation Current	8.8 Amps (Isat, 20% Drop In Inductance)
Temperature Range	-40/+125°C
Shielded	Yes
DC Resistance	15 mOhms
DC Resistance	15 mOhms

Statements of suitability for certain applications are based on our knowledge of typical operating conditions for such applications, but are not intended to constitute - and we specifically disclaim - any warranty concerning suitability for a specific customer application or use. This Information is intended for use only by customers who have the requisite experience and capability to determine the correct products for their application. Any technical advice inferred from this Information or otherwise provided by us with reference to the use of our products is given gratis, and we assume no obligation or liability for the advice given or results obtained.