

FLLE2400APX1I

Aliases (LLE2400APX1I)

Obsolete

EMI Filters, KEMET, FLLE2-PV, Chassis Mount, Noise Suppression, 300x130x100mm

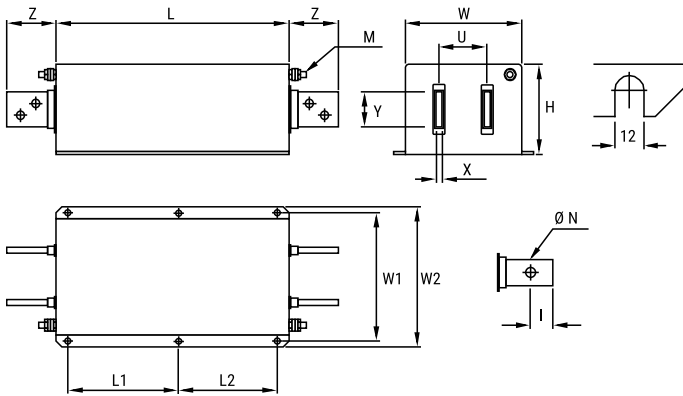

Click [here](#) for the 3D model.

General Information

Series	FLLE2-PV
Style	Chassis Mount
Description	EMI Filter, Without Y Capacitor
Features	Single Phase, Photovoltaic Applications
Phase	Single-phase
RoHS	Yes
Qualifications	IEC/EN 60939, UL 1283
Lead	Threaded Studs M10
Terminal Type	Threaded Studs M10

Dimensions

L	300mm NOM
W	130mm NOM
H	100mm NOM
L1	130mm NOM
L2	110mm NOM
W1	165mm NOM
W2	180mm NOM
U	70mm NOM
X	6mm NOM
Y	25mm NOM
Z	58mm NOM
I	15mm NOM
N	10.5mm NOM
M (Earth)	Threaded Studs M10
Lead	Threaded Studs M10

Specifications

Voltage DC	1200 VDC
Rated Current	400 A (50°C)
Ripple Current	400 A (50°C)
Rated Temperature	55°C
Temperature Range	-40/+100°C
Climate Category	40/100/21
Test Voltage DC (P to P)	3000 VDC
Test Voltage DC (P to E)	3600 VDC
Max Power Loss	15 W (25°C 50 Hz)

Packaging Specifications

Packaging	Bulk
Packaging Quantity	1
Typical Component Weight	7,000 g

Statements of suitability for certain applications are based on our knowledge of typical operating conditions for such applications, but are not intended to constitute - and we specifically disclaim - any warranty concerning suitability for a specific customer application or use. This Information is intended for use only by customers who have the requisite experience and capability to determine the correct products for their application. Any technical advice inferred from this Information or otherwise provided by us with reference to the use of our products is given gratis, and we assume no obligation or liability for the advice given or results obtained.